

STREET

EDGE

& B E Y O N D

COMPONENT SPEAKER  
USER GUIDE



## INTRODUCTION

This instruction manual is for your safety and must be adhered to at all times. Please read and ensure that you fully understand the installation and set up procedures as explained. If you are unclear on the installation or set up of your EDGE speakers please contact your nearest authorised EDGE dealer.

### Contents

- 2 x EDGE woofers
- 2 x EDGE tweeters
- 2 x EDGE crossovers
- 2 x woofer grills.
- 8 x Fixing screws.
- 1 x Cut out template.
- 2 x Lengths of speaker cable.
- Warranty card

### WARNING

DO NOT EXPOSE THIS PRODUCT TO DAMP OR MOISTURE - doing so may result in fire, shock or damage to the product.

BEFORE WIRING DISCONNECT THE CABLE FROM THE POSITIVE BATTERY TERMINAL - failure to do so may result in electric shock or injury.

ENSURE GOOD AND CORRECT CONNECTIONS - failure to make the correct connections may result in fire or damage to the product.

DO NOT USE ANY FUNCTIONS OF THIS EQUIPMENT THAT MAY TAKE YOUR CONCENTRATION AWAY FROM DRIVING YOUR VEHICLE - do not set up your amplifier whilst driving, doing so may result in an accident. For prolonged setting up, make sure that your vehicle is stationary and in a safe location.

KEEP THE VOLUME AT A LEVEL SO YOU CAN STILL HEAR OUTSIDE NOISE - failure to do this may result in an accident. EDGE equipment is capable of producing sound levels that can permanently damage your hearing. EDGE recommends caution when listening at high volume. For safe and enjoyable listening the sound should be comfortable and clear without distortion.

### CAUTION

Never connect any speaker lead to the car chassis. This can cause severe damage to your speaker /car radio /amplifier.

Before drilling or cutting any holes, investigate the layout of your vehicle thoroughly.

Use caution when working near the fuel / hydraulic lines and electrical wiring.

Observe the correct polarity when wiring, improper phasing may cause a loss of bass response.

Ensure that no moving parts catch on the speaker or grill (e.g. window or door handles, or window glass inside the door)

### Woofer Installation

Using the template provided find a suitable mounting location for the woofer.

Mark the mounting holes and pre drill the fixing hole with a 2mm drill bit. If the grill is too be fitted then place it over the speaker and screw through both the grill and the speaker using the provided screws. Be careful not to over tighten the screws as it may cause the grill to break.

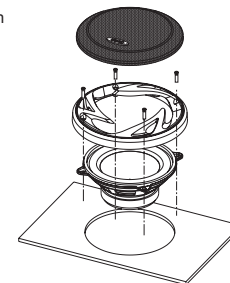

### Tweeter Installation Guidelines

The tweeter can either be fitted flush mount or surface mount. Try and take into account the following when locating a suitable position. For optimum staging try and locate a position that is higher than the woofer but within twelve inches (maximum) of it. It is vital that the tweeter is adjusted so that it is focused towards the listener.

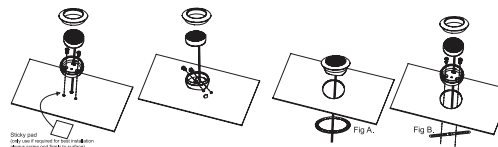

### Surface Mount Tweeter Installation

After finding a suitable position for the tweeters place the base of the tweeter casing in the correct position.

Using this base mark the two mounting holes and the hole for the wire to pass through. Cut out these holes using a 2mm drill for the fixing screws and at least an 8mm hole for the cable, ensure that the hole cut for the cable is big enough and will not cause the cable to become chafed in any way.

Pass the tweeter cable through the bottom of the case and through the previously drilled hole.

Secure the bass of the tweeter housing with the screws provided. Finally, angle the tweeter so that it is focused towards the listener.

## Flush Mount Tweeter Installation

**For ease of installation there are two ways of fixing the tweeters in place. The first requires the use of the metal ring provided. (See Figure A)**

After finding a suitable position for the tweeters place the cut out template for the tweeter in position and mark around it. Before cutting the holes double check that no brake, fuel lines or wiring harnesses are likely to get damaged.

Ensure that the tweeter when fitted will not catch on any moving parts such as door / window handles.

If mounting in a door check that the window can still be fully lowered before installing.

Cut out the hole carefully.

Place the entire tweeter into the cut out hole.

From the back push the metal ring over the rear of the casing until it is tight into the hole.

**The second requires the use of the metal strip provided. (See Figure B)**

After finding a suitable position for the tweeters place the cut out template for the tweeter in position and mark around it.

Before cutting the holes double check that no brake, fuel lines or wiring harnesses are likely to get damaged.

Ensure that the tweeter when fitted will not catch on any moving parts such as door / window handles.

If mounting in a door check that the window can still be fully lowered before installing.

Cut out the hole carefully.

Position the metal strip fixing strip centrally, behind the cut out hole.

Using the fixing screws attach the base of the tweeter case to the metal strip.

Pass the tweeter cable through the hole in the centre in the bottom of the case and the metal fixing strip.

Pull the cable tight until the tweeter sits in the base.

Screw the top of the tweeter casing to the base.

Caution do not over tighten.

## Wiring Examples

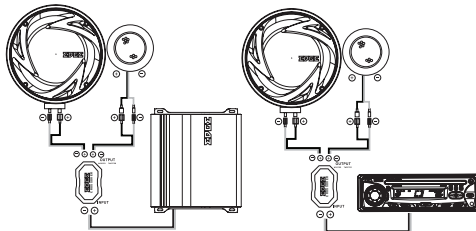

ED209 connected to amplifier (ED7400/  
ED7800/ED71600)

ED206 connected to ED901 CD/Tuner

## Limited Warranty

All EDGE goods are covered by a full 12 months manufacturers warranty. Valid from the date of the original receipt and proof of purchase. In order to validate this warranty, the warranty card should be returned to EDGE within seven days of the original purchase date. The original receipt and packaging should also be kept for this 12 month period.

If at any stage during the warranty period you have a problem with the product then it should be returned to the point of purchase in its original packaging, complete and with no items missing.

If the store is unable to fix the product it may have to be returned to EDGE this process takes around 7 working days.

A full description of EDGE's warranty information can be found on our website:  
[www.edgearaudio.com/warranty](http://www.edgearaudio.com/warranty)

A written version can also be obtained from  
EDGE warranty department  
PO Box 11000  
B75 7WG

## Copyright

All content included in this manual such as text, graphics, logos, icons, images data, the selection and arrangement thereof, are the property of EDGE Audio (herein referred to as "EDGE", "us" or "we") and its affiliate or their content and technology providers, and are protected by United Kingdom and International copyright laws. All rights reserved.

## Trademarks

EDGE ED2™, EDGE ED3™, EDGE ED4™, EDGE ED5™, EDGE ED6™, EDGE ED7™, EDGE Street™ and EDGE Loud™ and all stylised representations of product names, or the abbreviations of product names, as logos are all trademarks of EDGE. Graphics and logos are trademarks or trade dress of EDGE Audio or its subsidiaries.

EDGE's trademarks and trade dress may not be used in connection with any product or service that is not EDGE's, in any manner that is likely to cause confusion among customers or in any manner that disparages or discredits EDGE. All other trademarks not owned by EDGE or its subsidiaries that appear in this manual are the property of their respective owners, who may or may not be affiliated with, connected to, or sponsored by EDGE or its subsidiaries.

We reserve the right to make needed changes or improvements to the product and this manual, without informing the customer about this in advance

Model	Type	Configuration	Speaker size	RMS power	Peak power	Minimum input	Sensitivity	Frequency response	Mounting depth	Mounting diameter	Recommended amplifier
<b>ED306</b>	component	2 way	6.5" (165mm)	80 watts	240 watts	40 watts RMS	84.4dB	65Hz – 20KHz	57mm	144mm	ED7400/7800 ED71600
<b>ED305</b>	component	2 way	5.25" (130mm)	70 watts	210 watts	35 watts RMS	82.2dB	80Hz – 20KHz	54mm	114mm	ED7400/7800 ED71600



**EDGE**

**AUCTION**

**LIVE BY IT**